

AFT SYSTEM

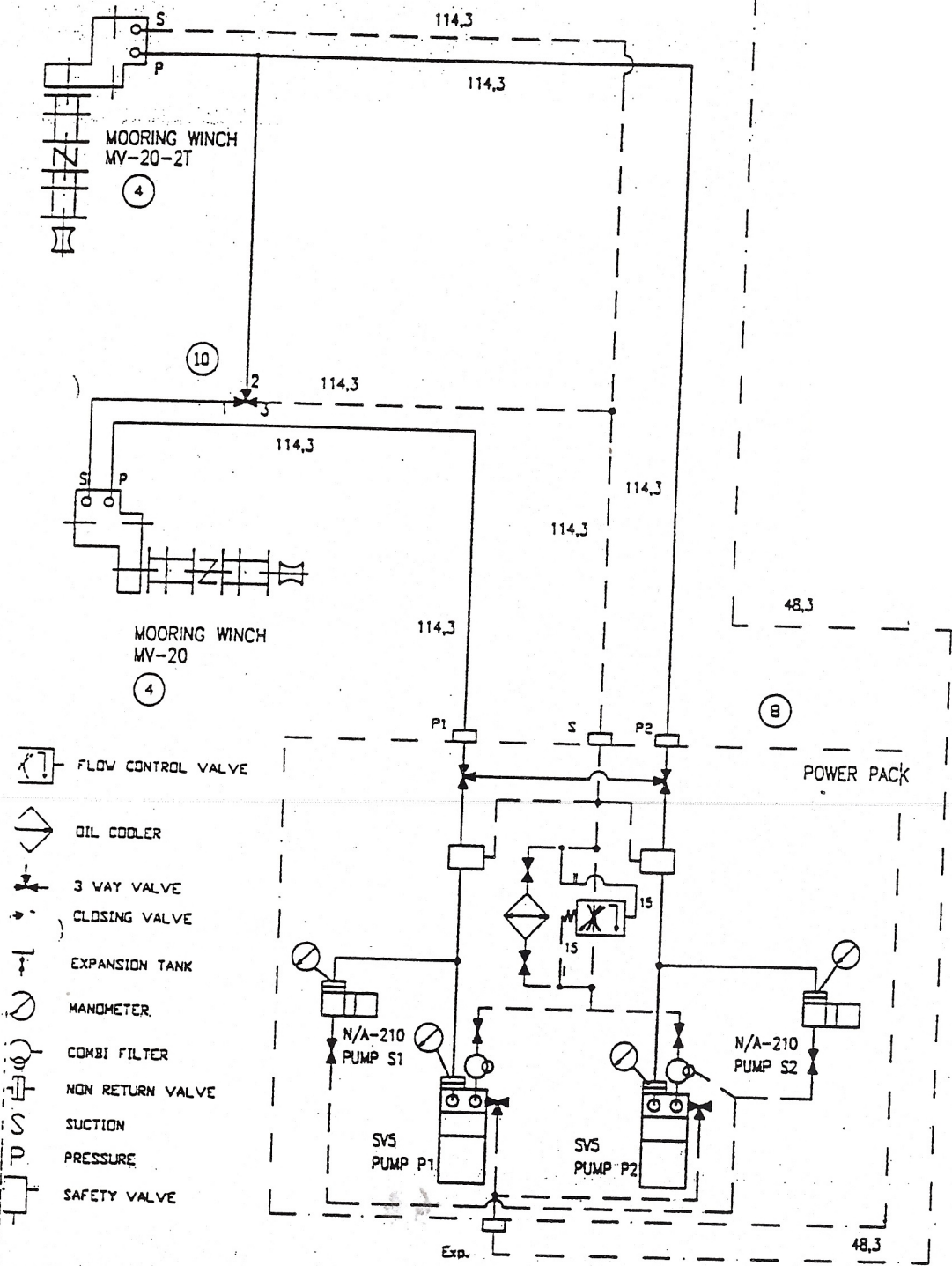

PIPES SHOULD BE LAID AS STRAIGHT AS POSSIBLE WITH A MINIMUM OF BENDS ALL THE WAY FROM THE PUMP TO THE HYDRAULIC MOTOR. USE LONG RADIUS BENDS IF POSSIBLE

AIR RELEASE PLUGS TO BE FITTED EVERYWHERE AIR POCKETS CAN OCCUR.

MINIMUM PIPE LENGTH 45m FOR EACH SYSTEM FOR COOLING PURPOSES IF OIL COOLER IS NOT FITTED

BOTTOM OF EXPANSION TANK TO BE MINIMUM 15m ABOVE HIGHEST POINT OF SYSTEM

PIPE CLEANING PROSEDURE, SEE DRAWING NO: 80-04.49

PIPE DIMENSIONS REFERED TO ON THIS PIPING DIAGRAM CONFORM TO DIN 2391 AND/OR 2448 ARE MINIMUM DIMENSIONS TO BE USED

MATERIAL AND WALL THICKNESS TO BE ACCORDING TO REQUIREMENTS STATED BY THE CLASSIFICATION SOCIETY FOR WORKING PRESSURE: p=50 bar FOR MAIN PIPES p= 50 bar FOR REMOTE CONTROL PIPES

DESIGN PRESSURE PIPE LINE	
—	PRESSURE LINE, 50 bar
- - -	RETURN LINE, 20 bar
- · - · -	EXPANSION LINE, 5 bar
TEST PRESS. = 1.5 x WORK PRESS.	

PIPES WALL THICKNESS TO BE IN ACC. WITH NI 300000K UP TO 88,9 MM OD. FOR DIMEN 114,3 MM WALL THICKNESS TO BE IN ACC. WITH DIN 2448 FOR 50 BAR PRESSURE, 75 B

PRECISION STEEL PIPES	PIPES TO EXPANSION TANK	STEEL PIPES FOR MAIN SYSTEM
30x1,6 10 12 15 18 22 28 35	42,4 48,3 60,3 60,3 76,1 88,9 114,3 129,7 168,3 193,7 219,1 244,5	